LA RONDE
COLLECTION
CHANEL

USER GUIDE
ENGLISH

ADJUSTING THE TIME

Crown C is normally placed in position 1.
Pull the crown out one notch (position 2), turn to move the hands to the desired time.
Remember to push the crown back fully to return it to its original position.



A - Hours hand
B - Minutes hand
C - Crown

HANDLING OF THE CLASPS

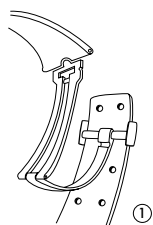

1. Double deployant buckle.
Size adjustment: lift upper part of the clasp and then slide the lug along the strap.

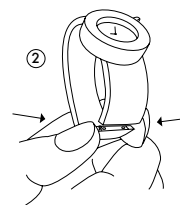

2. Steel bracelet : To open, on the "12 o'clock" section of the metal bracelet, press the buttons on each side simultaneously. To close: place the two "12 o'clock" section pins in the two appropriate holes in the "6 o'clock" section.